

## FEATURES & SPECIFICATIONS

**INTENDED USE** — Typical applications include corridors, lobbies, conference rooms and private offices.

**CONSTRUCTION** — Galvanized steel mounting/plaster frame; galvanized steel junction box with bottom-hinged access covers and spring latches. Reflectors are retained by torsion springs.

Vertically adjustable mounting brackets with commercial bar hangers provide 3-3/4" total adjustment.

Two combination 1/2"-3/4" and four 1/2" knockouts for straight-through conduit runs. Capacity: 8 (4 in, 4 out). No. 12 AWG conductors, rated for 90°C.

Accommodates 12"-24" joist spacing.

Passive cooling thermal management for 25°C standard; high ambient (40°C) option available. Light engine and drivers are accessible from above or below ceiling.

Max ceiling thickness 1-1/2".

**OPTICS** — LEDs are binned to a 3-step MacAdam Ellipse; 80 CRI minimum. 90 CRI optional.

LED light source concealed with diffusing optical lens.

General illumination lighting with 1.0 S/MH and 55° cutoff to source and source image.

Self-flanged anodized reflectors in specular, semi-specular, or matte diffuse finishes. Also available in white and black painted reflectors.

**A+ CAPABLE LUMINAIRE** — This item is an A+ capable luminaire, which has been designed and tested to provide consistent color appearance and out-of-the-box control compatibility with simple commissioning when used with Acuity Brands controls products. All configurations of this luminaire are calibrated and tested to meet the Acuity Brands' specifications for chromatic consistency – including color rendering, color fidelity and color temperature tolerance around standard CIE chromaticity coordinates. To learn more about A+ standards, specifications, and testing visit [www.acuitybrands.com/aplus](http://www.acuitybrands.com/aplus).

**UGR** — UGR is zero for fixtures aimed at nadir with a cut-off equal to or less than 60deg per CIE 117-1996 Discomfort Galre in Interior Lighting. [UGR FAQ](#)

**ELECTRICAL** — Multi-volt (120-277V, 50/60Hz) 0-10V dimming drivers mounted to junction box, 10% or 1% minimum dimming level available.

0-10V dimming fixture requires two (2) additional low-voltage wires to be pulled.

**LUMEN MAINTENANCE** — 70% lumen maintenance at 60,000 hours.

**LISTINGS** — Certified to US and Canadian safety standards. Wet location standard (covered ceiling). IP55 rated. ENERGY STAR® certified product. Drivers are ROHS compliant

**BUY AMERICAN ACT** — Product with the BAA option is assembled in the USA and meets the Buy America(n) government procurement requirements under FAR, DFARS and DOT regulations. Please refer to [www.acuitybrands.com/buy-american](http://www.acuitybrands.com/buy-american) for additional information.

**WARRANTY** — 5-year limited warranty. This is the only warranty provided and no other statements in this specification sheet create any warranty of any kind. All other express and implied warranties are disclaimed.

Complete warranty terms located at: [www.acuitybrands.com/support/warranty/terms-and-conditions](http://www.acuitybrands.com/support/warranty/terms-and-conditions)

**Note:** Actual performance may differ as a result of end-user environment and application.

All values are design or typical values, measured under laboratory conditions at 25 °C.

Specifications subject to change without notice.

## PERFORMANCE DATA

| LDN4    |        |         |      |
|---------|--------|---------|------|
| Nominal | Lumens | Wattage | Lm/W |
| 500     | 523.6  | 5.74    | 91.2 |
| 750     | 751.1  | 8.6     | 87.3 |
| 1000    | 1045   | 10.58   | 98.8 |
| 1500    | 1512   | 17.5    | 86.4 |
| 2000    | 2006   | 22.12   | 90.7 |
| 2500    | 2551   | 26.1    | 97.7 |
| 3000    | 3007   | 32.1    | 93.7 |
| 4000    | 4212   | 43      | 98.0 |

### Notes

Tested in accordance with IESNA LM-79-08

Tested to current IES and NEMA standards under stabilized laboratory conditions

Based on LDN4 AR LSS 35K 80CRI



|                |
|----------------|
| Catalog Number |
| Notes          |
| Type           |

# LDN4 STATIC WHITE

**4" Open and Wallwash LED Non-IC New Construction Downlight**

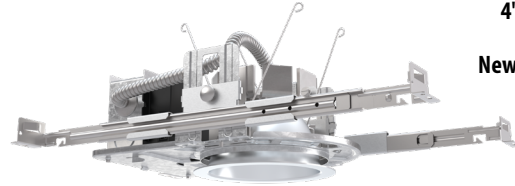

Open Trim



Wallwash Trim

## DISTRIBUTIONS

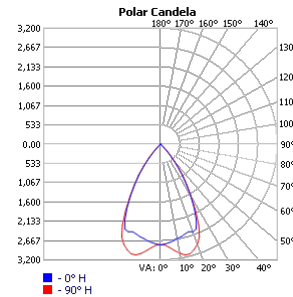

Open

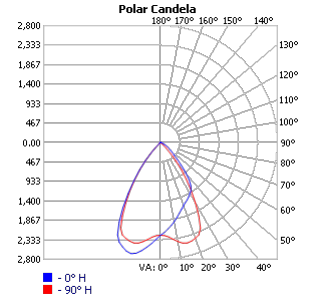

Wallwash

## DIMENSIONS

### LDN4 500-2000 Lumens

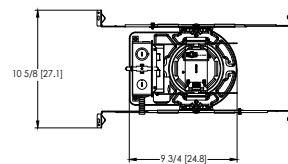

Aperture: Ø 4-5/16" [111]  
 Ceiling Cutout: Ø 5-1/8" [133] Self-flanged  
 Overlap Trim: Ø 5-7/16" [13.8]  
 Ceiling Cutout: Ø 5-1/4" [13.3] Flangeless

See page 4 for other fixture dimensions

ORDERING INFORMATION

Lead times will vary depending on options selected. Consult with your sales representative.

Example: LDN4 35/15 L04 AR LSS MVOLT EZ1

| Series        | Color temperature   | Lumens ‡   | Trim Style   | Trim Color                    | Trim Finish  | Flange Color ‡                                       |   |
|---------------|---|--|--|-------------------------------|--|--|---|
| LDN4 4" round | 27/ 2700K<br>30/ 3000K<br>35/ 3500K<br>40/ 4000K<br>50/ 5000K | 05 500 lumens<br>07 750 lumens<br>10 1000 lumens<br>15 1500 lumens | 20 2000 lumens<br>25 2500 lumens<br>30 3000 lumens<br>40 4000 lumens | L04 Downlight<br>LW4 Wallwash | AR Clear<br>WR ‡ White<br>BR ‡ Black<br>TRALTBD ‡ RAL painted trim<br>TCPC ‡ Custom painted trim | LSS Semi-specular<br>LD Matte diffuse<br>LS Specular | TRW White painted flange<br>TRBL Black painted flange<br>FRALTBD RAL painted flange only<br>FCPC Custom painted flange only |

| Voltage  | Driver  | Emergency ‡  | Control Input ‡  |
|--|---|--|--|
| MVOLT Multi-volt<br>120 120V<br>277 277V<br>347 ‡ 347V | GZ10 0-10V driver dims to 10%<br>GZ1 0-10V driver dims to 1%<br>D10 Minimum dimming 10% driver for use with JOT<br>D1 Minimum dimming 1% driver for use with JOT<br>EZ1 0-10V eldoLED driver with smooth and flicker-free deep dimming performance down to 1%<br>EDAB eldoLED DALI SOLDRIVE dim to dark | (blank) No emergency option<br>EL Emergency battery pack with integral test switch. 10W Constant Power, Not Certified in CA Title 20 MAEDBS<br>ELR Emergency battery pack with remote test switch. 10W Constant Power, Not Certified in CA Title 20 MAEDBS<br>ELSD Emergency battery pack with self-diagnostics, 10W Constant Power, integral test switch. Not Certified in CA Title 20 MAEDBS<br>ELRSD Emergency battery pack with self-diagnostics, 10W Constant Power, remote test switch. Not Certified in CA Title 20 MAEDBS<br>E10WCP Emergency battery pack, 10W Constant Power with integral test switch. Certified in CA Title 20 MAEDBS<br>E10WCPR Emergency battery pack, 10W Constant Power with remote test switch. Certified in CA Title 20 MAEDBS<br>E10WRSTAR Emergency battery pack, 10W with remote test switch and lota STAR technology | (blank) No control option<br>NPP16D nLight™ network power/relay pack with 0-10V dimming for non-eldoLED drivers (GZ10, GZ1).<br>NPP16DER nLight™ network power/relay pack with 0-10V dimming for non-eldoLED drivers (GZ10, GZ1). ER controls fixtures on emergency circuit.<br>N80 nLight™ Lumen Compensation<br>JOT Wireless room control with "Just One Touch" pairing<br>NPS80EZ nLight™ dimming pack controls 0-10V eldoLED drivers (EZ10, EZ1).<br>NPS80EZER nLight™ dimming pack controls 0-10V eldoLED drivers (EZ10, EZ1). ER controls fixtures on emergency circuit.<br>NLTAIR2 nLight™ Air enabled<br>NLTAIRER2 nLight™ AIR Dimming Pack Wireless Controls. Controls fixtures on emergency circuit, not available with battery pack options<br>NLTAIREM2 nLight™ AIR Dimming Pack Wireless Controls. UL924 Emergency Operation, via power interrupt detection. Available with battery pack options. |

| Options |  |
|---------|--|
| HAO ‡   | High ambient option (40°C)   |
| CP ‡    | Chicago Plenum   |
| RRL     | RELOC®-ready luminaire connectors enable a simple and consistent factory installed option across all ABL luminaire brands. Refer to RRL for complete nomenclature. Available only in RRLA, RRLB, RRLAE, and RRLC12S. |
| BAA     | Buy America(n) Act Compliant   |
| 90CRI   | High CRI (90+)   |
| SF ‡    | Single fuse  |

 Items marked by a shaded background qualify for the Design Select program and ship in 15 days or less. To learn more about Design Select, visit [www.acuitybrands.com/designselect](http://www.acuitybrands.com/designselect). \*See ordering tree for details

(Maximum order quantity for design select lead times is 160.)

| ‡ Option Value Ordering Restrictions |   |
|--------------------------------------|---|
| Option value                         | Restriction   |
| Lumen Packages                       | Overall height varies based on lumen package, refer to dimensional charts on page 4   |
| WR, BR                               | Not available with finish (LSS, LD, LS)   |
| TRALTBD, FRALTBD                     | RALTBD for pricing only. Replace with applicable RAL number and finish when ready to order. See the RAL BROCHURE for available color options.   |
| TRW, TRBL                            | Available with clear (AR) trim color only   |
| TCPC, FCPC                           | CPC options for pricing only. Custom color chip needs to be sent in to your Customer Resolution specialist before order can be processed. Click <a href="#">HERE</a> for more details   |
| 347                                  | Not available with emergency options  |
| All Emergency                        | 12.5" of plenum depth or top access required for battery pack maintenance.  |
| NPP16D, NPP16DER                     | Not available with MVOLT. ER for use with generator supply EM power. Will require an emergency hot feed and normal hot feed.  |
| SF                                   | Must specify 120 or 277 volt  |
| N80                                  | Fixture begins at 80% light level. Must be specified with NPS80EZ or NPS80EZER. Only available with EZ10 and EZ1 drivers.   |
| NPP16D, NPP16DER, NPS80EZ, NPS80EZER | Specify voltage. ER for use with generator supply EM power. Will require an emergency hot feed and normal hot feed.   |
| NLTAIR2, NLTAIRER2, NLTAIREM2        | Not available with CP, NPS80EZ, NPS80EZER, NPP16D, NPP16DER or N80 options. Not recommended for metal ceiling installations.  |
| NLTAIR2                              | When combined with EZ1 or EZ10 drivers, can be used as a normal power   |
| JOT                                  | Must specify D10 or D1 driver. Not available with nLight options. Not available with CP. Not recommended for metal ceiling installation. Not for use with emergency backup power systems other than battery packs.  |
| HAO                                  | Fixture height is 5-11/16" for all lumen packages with HAO.   |
| CP                                   | Must specify voltage for 3000lm. Not available with emergency battery pack option.  |
| E10WRSTAR                            | Not available with wet location, EC1, EC6, QDS, CP, 347V, NPS80EZ ER, NLTAIRER2, NLTAIREM2, ALO3 & ALO4 w/DALI, OR 2000-4500 lumens w/JOT. Top access installation or 17.5" plenum clearance required for roomside installation. Not available with integral test switch. |

**Accessories:** Order as separate catalog number.

|                             |  |
|-----------------------------|--|
| PS1055CP                    | FMC Power Sentry batterypack, T20 compliant, field installable, 10w constant power                     |
| <a href="#">EACISSM 375</a> | Compact interruptible emergency AC power system  |
| <a href="#">EACISSM 125</a> | Compact interruptible emergency AC power system  |
| GRA46 JZ                    | Oversized trim ring with 6" outside diameter   |
| SCA4                        | Sloped Ceiling Adapter. Degree of slope must be specified (5D, 10D, 15D, 20D, 25D, 30D). Ex: SCA4 10D. |

**Emergency Battery Pack Options - Field Installable**

| Battery Model Number                | Wattage | Runtime (Minutes) | Lumen Output* @ 120 Lumens/Watt | Other  |
|-------------------------------------|---------|-------------------|---------------------------------|--|
| <a href="#">ILB CP07 2H A</a>       | 7W      | 120               | 840                             | Storm Shelter/ 2-hour Runtime                |
| <a href="#">ILB CP10 A</a>          | 10W     | 90                | 1200                            |  |
| <a href="#">ILBLP CP10 HE SD A+</a> | 10W     | 90                | 1200                            | Title 20, Self Diagnostic                    |
| <a href="#">ILBLP CP15 HE SD A+</a> | 15W     | 90                | 1800                            | Title 20, Self Diagnostic                    |
| <a href="#">ILB CP20 HE A</a>       | 20W     | 90                | 2400                            | Title 20                                     |
| <a href="#">ILB CP20 HE SD A</a>    | 20W     | 90                | 2400                            | Title 20, Self Diagnostic                    |
| <a href="#">ILBHI CP10 HE SD A+</a> | 10W     | 90                | 1200                            | 347-480V AC Input, Title 20, Self Diagnostic |
| <a href="#">ILBHI CP15 HE SD A+</a> | 15W     | 90                | 1800                            | 347-480V AC Input, Title 20, Self Diagnostic |

All the above are UL 924 Listed products that are certified for field install external/remote to the fixture.

\*Minimum delivered lumen output to assist in product selection for increased fixture mounting height.

The CP10 delivered emergency illuminations outperforms legacy 1400 lumen fluorescent emergency ballasts.

Please contact us at [techsupport@iotaengineering.com](mailto:techsupport@iotaengineering.com) for any Emergency Battery related questions.

## PHOTOMETRY

### Distribution Curve

### Distribution Data

### Output Data

### Illuminance Data at 30" Above Floor for a Single Luminaire

**LDN4 35/30 L04AR**, input watts: 32.1, delivered lumens: 3122.6, LM/W = 88.52, spacing criterion at 0= 1.04, test no. ISF 30712P249.

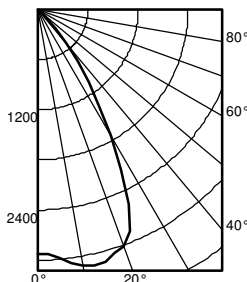

| Ave | Lumens | Zone       | Lumens | % Lamp      |
|-----|--------|------------|--------|-------------|
| 0   | 2927   | 0° - 30°   | 2301.2 | 73.7        |
| 5   | 2989   | 0° - 40°   | 2968.2 | 95.1        |
| 15  | 3120   | 0° - 60°   | 3121.1 | 100.0       |
| 25  | 2575   | 0° - 90°   | 3122.6 | 100.0       |
| 35  | 1062   | 90° - 120° | 0.0    | 0.0         |
| 45  | 149    | 90° - 130° | 0.0    | 0.0         |
| 55  | 3      | 90° - 150° | 0.0    | 0.0         |
| 65  | 2      | 90° - 180° | 0.0    | 0.0         |
| 75  | 0      | 0° - 180°  | 3122.6 | *100.0      |
| 85  | 0      |            |        | *Efficiency |
| 90  | 0      |            |        |             |

| Mounting Height | Initial FC    |           | 50% beam - 55.6° |      | 10% beam - 78.0° |    |
|-----------------|---------------|-----------|------------------|------|------------------|----|
|                 | Beam Diameter | Center FC | Diameter         | FC   | Diameter         | FC |
| 8.0             | 96.8          | 5.8       | 48.4             | 8.9  | 9.7              |    |
| 10.0            | 52.0          | 7.9       | 26.0             | 12.2 | 5.2              |    |
| 12.0            | 32.4          | 10.0      | 16.2             | 15.4 | 3.2              |    |
| 14.0            | 22.1          | 12.1      | 11.1             | 18.6 | 2.2              |    |
| 16.0            | 16.1          | 14.2      | 8.0              | 21.9 | 1.6              |    |

| LUMEN OUTPUT MULTIPLIERS - CCT |       |       |       |       |       |
|--------------------------------|-------|-------|-------|-------|-------|
|                                | 2700K | 3000K | 3500K | 4000K | 5000K |
| 80CRI                          | 0.950 | 0.966 | 1.000 | 1.025 | 1.101 |

| LUMEN OUTPUT MULTIPLIERS - FINISH |            |            |            |
|-----------------------------------|------------|------------|------------|
|                                   | Clear (AR) | White (WR) | Black (BR) |
| Specular (LS)                     | 1.0        | N/A        | N/A        |
| Semi-specular (LSS)               | 0.950      | N/A        | N/A        |
| Matte diffuse (LD)                | 0.85       | N/A        | N/A        |
| Painted                           | N/A        | 0.87       | 0.73       |

### HOW TO ESTIMATE DELIVERED LUMENS IN EMERGENCY MODE

Use the formula below to estimate the delivered lumens in emergency mode

**Delivered Lumens = 1.25 x P x LPW**

P = Output power of emergency driver. P = 10W for PS1055CP

LPW = Lumen per watt rating of the luminaire. This information is available on the ABL luminaire spec sheet.

The LPW rating is also available at [Designlight Consortium](http://Designlight Consortium).

- Notes**
- Tested in accordance with IESNA LM-79-08.
  - Tested to current IES and NEMA standards under stabilized laboratory conditions.
  - CRI: 80 typical.

# LDN4

\* All dimensions are inches (centimeters) unless otherwise noted.

## LDN4 500-2000 Lumens

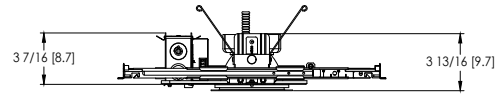
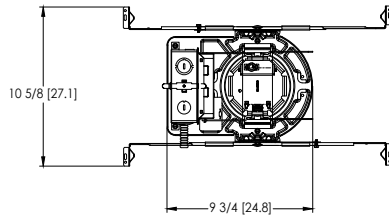

Aperture:  $\varnothing$  4-5/16" [11]  
 Ceiling Cutout:  $\varnothing$  5-1/8" [13] Self-flanged  
 Overlap Trim:  $\varnothing$  5-7/16" [13.8]  
 Ceiling Cutout:  $\varnothing$  5-1/4" [13.3] Flangeless

## LDN4 2000-4000 Lumens

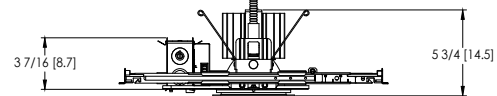
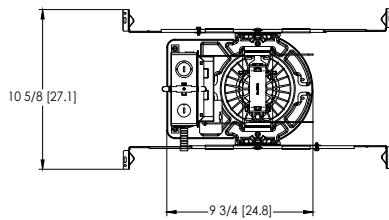

Aperture:  $\varnothing$  4-5/16" [11]  
 Ceiling Cutout:  $\varnothing$  5-1/8" [13] Self-flanged  
 Overlap Trim:  $\varnothing$  5-7/16" [13.8]  
 Ceiling Cutout:  $\varnothing$  5-1/4" [13.3] Flangeless

## LDN4 CP

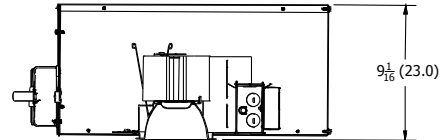
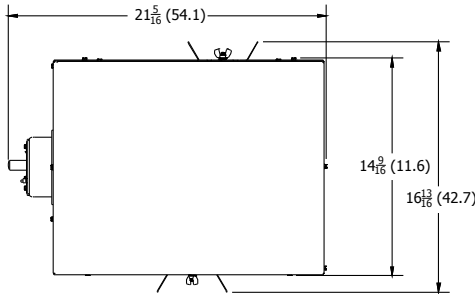

Aperture: 4-5/16" (11)  
 Ceiling Opening: 5-1/8" (13)  
 Overlap Trim: 5-7/16" (13.8)

## LDN4 EL

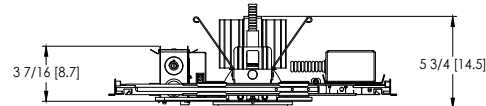
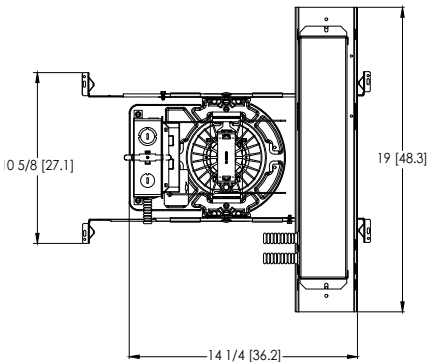

Aperture:  $\varnothing$  4-5/16" [11]  
 Ceiling Cutout:  $\varnothing$  5-1/8" [13] Self-flanged  
 Overlap Trim:  $\varnothing$  5-7/16" [13.8]  
 Ceiling Cutout:  $\varnothing$  5-1/4" [13.3] Flangeless

## ADDITIONAL DATA



The Sensor Switch JOT enabled solution offers a wireless, app-free approach to single room lighting control. JOT enabled products use Bluetooth® Low Energy (BLE) technology to enable wireless dimming and switching.

### Diagram



LDN4 Series



Sensor Switch  
WSXA JOT

1. **Power:** Install JOT enabled fixtures and controls as instructed.
2. **Pair:** Insert the pairing tool into the pinhole on the wall switch; press and hold any button for 6 seconds.
3. **Play:** Once paired, each fixture will individually dim down to 10% brightness. All products will be fully functional.

| COMPATIBLE 0-10V WALL-MOUNT DIMMERS |   |                         |
|-------------------------------------|---|-------------------------|
| MANUFACTURER                        | PART NO.  | POWER BOOSTER AVAILABLE |
| Lutron®                             | Diva® DDTV  |                         |
|                                     | Diva® DVSC TV   |                         |
|                                     | Nova T® NTFTV   |                         |
|                                     | Nova® NFTV  |                         |
| Leviton®                            | AWSMT-7DW   | CN100                   |
|                                     | AWSMG-7DW   | PE300                   |
|                                     | AMRMG-7DW   |                         |
|                                     | Leviton Centura Fluorescent Control System                                    |                         |
|                                     | IllumaTech® IP7 Series  |                         |
| Synergy®                            | ISD BC  | RDMFC                   |
|                                     | SLD LPCS  |                         |
|                                     | Digital Equinox (DEQ BC)  |                         |
| Douglas Lighting Controls           | WPC-5721  |                         |
| Entertainment Technology            | Tap Glide TG600FAM120 (120V)  |                         |
|                                     | Tap Glide Heatsink TGH1500FAM120 (120V)                                       |                         |
|                                     | Oasis OA2000FAMU  |                         |
| Honeywell                           | EL7315A1019   | EL7305A1010 (optional)  |
|                                     | EL7315A1009   |                         |
| HUNT Dimming                        | Preset slide: PS-010-IV and PS-010-WH   |                         |
|                                     | Preset slide: PS-010-3W-IV and PS-010-3W-WH                                   |                         |
|                                     | Preset slide, controls FD-010: PS-IFC-010-IV and PS-IFC-010-WH-120/277V       |                         |
|                                     | Preset slide, controls FD-010: PS-IFC-010-3W-IV and PS-IFC-010-3W-WH-120/277V |                         |
|                                     | Remote mounted unit: FD-010   |                         |
| Lehigh Electronic Products          | Solitaire   | PBX                     |
| PDM Electrical Products             | WPC-5721  |                         |
| Starfield Controls                  | TR61 with DALI interface port   | RT03 DALInet Router     |
| WattStopper®                        | LS-4 used with LCD-101 and LCD-103  |                         |

## EXAMPLE

Group Fixture Control\*

\*Application diagram applies for fixtures with eldoLED drivers only.

**nPS 80 EZ** Dimming/Control Pack (qty: 2 required)

**nPODM 2P DX** Dual On/Off/Dim Push-Button WallPod

**nCM ADCX** Daylight Sensor with Automatic Dimming Control

**nCM PDT 9** Dual Technology Occupancy Sensor

**Description:** This design provides a dual on/off/dim wall station that enables manual control of the fixtures in Row A and Row B separately. Additionally, a daylight harvesting sensor is provided so the lights in Row B can be configured to dim automatically when daylight is available. An occupancy sensor turns off all lights when the space is vacant.

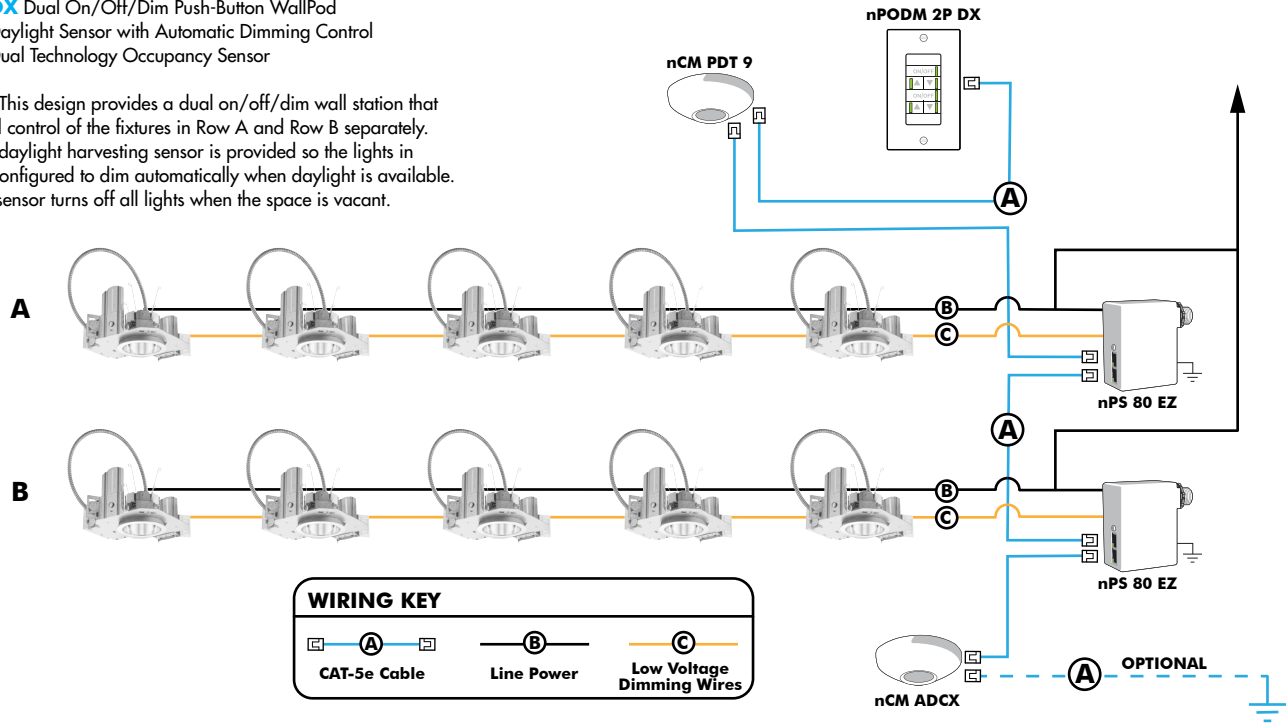

## Choose Wall Controls

nLight offers multiple styles of wall controls - each with varying features and user experience.



### Push-Button Wallpod

Traditional tactile buttons and LED user feedback



### Graphic Wallpod

Full color touch screen provides a sophisticated look and feel

## nLight® Wired Controls Accessories:

| Order as separate catalog number. Visit <a href="http://www.acuitybrands.com/products/controls/nlight">www.acuitybrands.com/products/controls/nlight</a> for complete listing of nLight controls. |                  |  |                             |
|---|------------------|--|-----------------------------|
| WallPod Stations  | Model number     | Occupancy sensors                          | Model Number                |
| On/Off  | nPODM (Color)    | Small motion 360°, ceiling (PIR/dual Tech) | nCM 9 / nCM PDT 9           |
| On/Off & Raise/Lower  | nPOD DX (Color)  | Large motion 360°, ceiling (PIR/dual tech) | nCM 10 / nCM PDT 10         |
| Graphic Touchscreen   | nPOD GFX (Color) | Wide View (PIR/dual tech)                  | nWV 16 / nWV PDT 16         |
| Photocell controls  | Model Number     | Wall Switch w/ Raise/Lower (PIR/dual tech) | nWSX LV DX / nWSX PDT LV DX |
| Dimming   | nCM ADCX         | Cat-5 cables (plenum rated)                | Model Number                |
|   |                  | 10', CAT5 10FT                             | CAT5 10FT J1                |
|   |                  | 15, CAT5 15FT                              | CAT5 15FT J1                |

## nLight® AIR Control Accessories:

Order as separate catalog number. Visit [www.acuitybrands.com/products/controls/nlightair](http://www.acuitybrands.com/products/controls/nlightair).

| Wall switches                    | Model number              |
|----------------------------------|---------------------------|
| On/Off single pole               | rPODB [color]             |
| On/Off two pole                  | rPODB 2P [color]          |
| On/Off & raise/lower single pole | rPODB DX [color]          |
| On/Off & raise/lower two pole    | rPODB 2P DX [color]       |
| On/Off & raise/lower single pole | rPODBZ DX WH <sup>1</sup> |

### Notes

- 1 Can only be ordered with the RES7Z zone control sensor version.

## UL924 Sequence of Operation

The below information applies to all nLight AIR devices with an EM option.

- EM devices will remain at their high-end trim and ignore wireless lighting control commands, unless a normal-power-sense (NPS) broadcast is received at least every 8 seconds.
- Using the CLAIRITY+ mobile app, EM devices must be associated with a group that includes a normal power sensing device to receive NPS broadcasts.
- Only non-emergency rPP20, rLSXR, rSBOR, rSDGR, and nLight AIR luminaires with version 3.4 or later firmware can provide normal power sensing for EM devices. See specification sheets for control devices and luminaires for more information on options that support normal power sensing.

## nLight AIR

nLight AIR is the ideal solution for retrofit or new construction spaces where adding communication is cost prohibitive. The integrated nLight AIR rPP20 Power Pack is part of each Lithonia LDN Luminaire. These individually addressable controls offer the ultimate in flexibility during initial setup and for space repurposing.

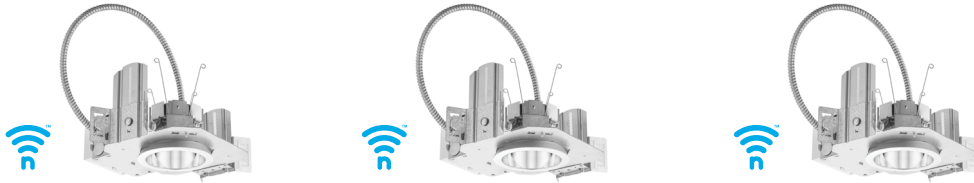

## Simple as 1,2,3

1. Install the nLight® AIR fixtures with embedded smart sensor
2. Install the wireless battery-powered wall switch
3. With CLAIRITY app, pair the fixtures with the wall switch and if desired, customize the sensor settings for the desired outcome

